

# UNPACKING

## 1. PACKING LOCATION

▼ 1	▼ 2
KEY	BALL
▼ 3	▼ 4
ACCESSORY ENVELOPE	BILLBOARD ASS'Y

## 2. BUTTON PLATE ASS'Y DISASSEMBLY

**- Please use the hand driver in the store.**

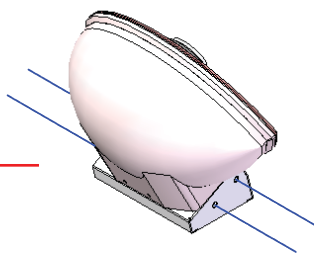
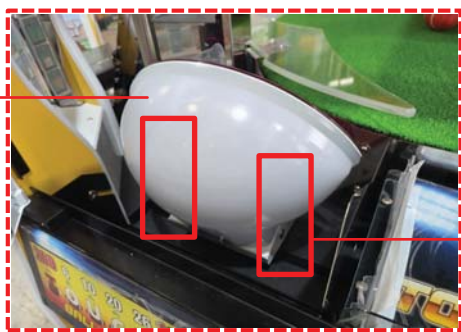

- ① Separated into 2 parts on the left and right sides [4 places] - Reuse the removed bolts

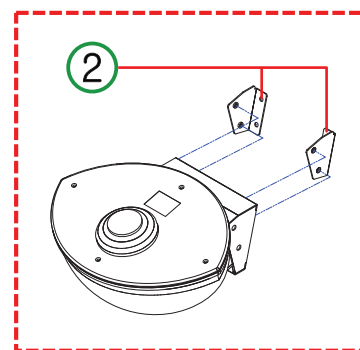

Internal 2-type BKT separation [4 places]  
- You can throw it away



**\* Afterwards, please assemble the button plate using the installation manual.  
Be sure to remove the button plate and then remove the side panel bolts.**