







[QR CODE]

*** If a problem occurs, enter the appropriate QR code. Once connected, you can watch a YouTube video about the inspection details.**

NO	DEFECT SYMPTOM	QR CODE
1	E.31 BIG WIN MOTOR ERROR : UP SENSOR E.32 BIG WIN MOTOR ERROR : DOWN SENSOR	E.31,32 
2	E.33 BIG WIN MOTOR ERROR : NO CHANGE OF POSITION SENSOR E.34 BIG WIN MOTOR ERROR : ABNORMAL SIGNAL POSITION SENSOR	E.33,34 
3	E.41 STOPPER MOTOR ERROR : EQUINOX SENSOR	E.31,32 

4	E.42 STOPPER MOTOR ERROR : STARTING SENSOR	E.42 
5	E.51 SLOPE SENSOR ERROR : CONTINUS OF SENSOR SIGNAL	E.51 
6	E.52 SLOPE SENSOR ERROR : CAR STOPS WHILE MOVING	E.52 
7	E.53 SLOPE SENSOR ERROR : ABNORMAL IN SEQUENCE OF SENSOR	E.53 

*** ANDAMIRO WARRANTS the parts from date of shipment as follows.**

- One Year Limited Warranty : Electronic Boards

- 6 Month Limited Warranty : Moving Parts

CONTENTS

1. ERROR CODEP04
2. TEST MODEP08
3. TROUBLESHOOTINGP11
4. WARRANTY ITEM & PART PICTUREP20

[1. ERROR CODE]

- ALL GAMES STOP WHEN ERROR “Er.02” AND “Er.03” HAPPEN BUT GAME WILL BE CONTINUED AGAINST ALL OTHER ERRORS, EXCEPT FOR THE PLAYER WITH ERROR.
(TICKET ERROR “HELP” DOES NOT STOP THE GAME)

ERROR CODE	ERROR TYPE	CONTENTS	CHECK POINTS
Er.02	SYSTEM	PROBLEM AT SETUP SAVE DATA	1. CHECK SET UP STATUS AND SAVE 2. DO FACTORY SETTING 3. CHECK POWER ON, OFF 4. REPLACE MAIN BOARD IF PROBLEM IS STILL NOT SOLVED
Er.03		PROBLEM AT GAME SAVE DATA	1. CLEAR DATA AT SET UP CLEAR MODE 2. CHECK POWER ON, OFF 3. REPLACE MAIN BOARD IF PROBLEM IS STILL NOT SOLVED
Er.11	COIN SELECTOR	CONTINUOUS EXISTENCE OF COIN SENSOR SIGNAL	CHECK COIN SELECTOR SENSOR INPUT OF THE PLAYER IN ERROR
Er.13	BILL ACCEPTER	CONTINUOUS EXISTENCE OF BILL ACCEPTER SENSOR SIGNAL	CHECK BILL ACCEPTER SENSOR INPUT OF THE PLAYER IN ERROR
Er.31	BIG WIN MOTOR	CONTINUOUS EXISTENCE OF #1 (UP) LIMIT SENSOR	1. CHECK OPERATION STATUS OF MOTOR 2. CHECK INPUT STATUS OF SENSOR
Er.32		CONTINUOUS EXISTENCE OF #2 (DOWN) LIMIT SENSOR	1. CHECK OPERATION STATUS OF MOTOR 2. CHECK INPUT STATUS OF MOTOR
Er.33		NO CHANGE OF POSITION SENSOR SIGNAL	1. CHECK OPERATION STATUS OF MOTOR 2. CHECK INPUT STATUS OF SENSOR
Er.34		ABNORMAL POSITION SENOR SIGNAL	1. CHECK CHECKER BRACKET STATUS 2. CHECK INPUT STATUS OF SENSOR
Er.41	STOPPER MOTOR	NO ENCODER EQUINOX SIGNAL	1. CHECK OPERATION STATUS OF MOTOR 2. CHECK ENCODER SENSOR INPUT STATUS
Er.42		NO ENCODER STARTING POINT SIGNAL	1. CHECK OPERATION STATUS OF MOTOR 2. CHECK ENCODER SENSOR INPUT STATUS

Er.51	SLOPE SENSOR	CONTINUS EXISTENCE OF SENSOR SIGNAL	1. CHECK OPERATION STATUS OF CAR 2. CHECK INPUT STATUS OF SENSOR.
Er.52		CAR STOPS WHILE MOVING	1. CHECK OPERATION STATUS OF CAR 2. CHECK STATUS OF SENSOR INPUT
Er.53		ABNORMAL IN SEQUENCE OF SENSOR	1. CHECK STATUS OF SENSOR INPUT 2. CHECK WIRING STATUS OF SENSOR
HELP	TICKET ERROR	NO TICKETS	1. CHECK TICKETS 2. CHECK OPERATION OF TICKET MOTOR 3. CHECK TICKET DISPENSING SENSOR
- ERROR CODE IS DISPLAYED AT TICKET FND / RETRY FND OF THE PLAYER WITH ERROR (FOR DISPLAY OF ERROR CODE, PLEASE REFER TO DESCRIPTION ITEMS OF TEST MODE)			

- ERROR CODE& ERROR DETECTION METHOD

ERROR CODE	ERROR TYPE	CONTENTS	ERROR CHECK CONDITION
Er.02	SYSTEM	PROBLEM AT SETUP SAVE DATA	AFTER POWER IS TURNED ON, CHECK BACK-UP MEMORY RELATED WITH MAIN BOARD SETUP
Er.03		PROBLEM AT GAME SAVE DATA	AFTER POWER IS TURNED ON, CHECKBACK-UP MEMORY RELATED WITH MAIN BOARD GAME
Er.11	COIN SELECTOR	CONTINUOUS EXISTENCE OF COIN SENSOR SIGNAL	SIGNAL KEEPS ON FOR MORE THAN TWO SECONDS WHEN INHIBIT IS ON
Er.13	BILL ACCEPTER	CONTINUOUS EXISTENCE OF BILL ACCEPTER SENSOR SIGNAL	SENSOR SIGNAL KEEPS ON FOR MORE THAN TWO SECONDS
Er.31	BIG WIN MOTOR	CONTINUOUS EXISTENCE OF #1 (UP) LIMIT SENSOR	SENSOR SIGNALS KEEPS ON FOR MORE THAN TWO SECONDS
Er.32		CONTINUOUS EXISTENCE OF #2 (DOWN) LIMIT SENSOR	SENSOR SIGNAL KEEPS ON FOR MORE THAN TWO SECONDS
Er.33		NO CHANGE AT POSITION SENSOR SIGNAL	NO CHANGE AT SENSOR SIGNAL FOR MORE THAN TWO SECONDS DURING OPERATION OF MOTOR
Er.34		ABNORMALITY AT POSITION SENOR SIGNAL	CONDITION OF POSITION SENSOR COUNT IS NOT MET DURING BOOT TEST
Er.41	STOPPER MOTOR	NO ENCODER EQUINOX SIGNAL	NO SIGNAL FROM ENCODER EQUINOX FOR MORE THAN 0.5 SECOND WHILE MOTOR IS BEING OPERATED (DISPLAY OF ERROR AFTER 3 TIMES REVERSE-ROTAING)
Er.42		NO ENCODER STARTING POINT SIGNAL	NO SIGNAL FROM ENCODER STARTING POINT SENSOR FOR OVER 3 SECONDS DURING INCREASE OPERATION

Er.51	SLOPE SENSOR	CONTINUS EXISTENCE OF SENSOR SIGNAL	SENSOR SIGNAL KEEPS ON FOR MORETHAN THREE SECONDS
Er.52		CAR STOPS WHILE MOVING	NO SIGNAL FOR OVER 10 SECONDS WHILE CAR IS MOVING
Er.53		ABNORMAL IN SEQUENCE OF SENSOR	NO RECOGNIZING THE SIGNAL ACCORDING TO SEQUENCE OF SENSOR WHILE MOVING THE CAR
HELP	TICKET ERROR	NO TICKETS	NO TICKET SENSOR SIGNAL FOR MORE THAN ONE SECOND WHILE DISPENSING TICKETS

[2. TEST MODE]

TEST MODE			
TEST ITEMS	SET UP ITEMS		DESCRIPTION
INPUT TEST	[=>]		ENTER INTO CHECK MODE OF INPUT STATUS
	DISPLAY OF INPUT STATUS OF EACH ITEM AT LCD		
	(BUTTON, COIN, TICKET, SENSOR... ETC)		
FND & LAMP	LAMP, FND, LED OPERATION TEST		
	“ OFF ”		TOTAL OFF
	“STEP”	LAMP	▶TOTAL ON, OFF FLICKERING ▶BOTTOM LAMP ON ▶1P/2P TICKET LAMP ON ▶1P/2P START BUTTON LAMP ON ▶HOW TO LAMP ON ▶1P/2P CAR SPOT LAMP ON ▶1P/2P RETRY LAMP ON ▶BILLBOARD LAMP ON REPEATS IN ABOVE SEQUENCE
		FND	▶TOTAL ON, OFF FLICKERING ▶TOTAL NUMBER COUNT [0000] ~ [9999] ▶CREDIT 1P [00] / 2P [11], RETRY 1P [22] / 2P [33] ▶TICKET 1P [4444] / 2P [5555] ▶SCORE [000] ~ [666], BIGWIN [7777] REPEATS IN ABOVE SEQUENCE
		LED	▶TOTAL WHITE ON, OFF FLICKERING ▶TURNING ON IN SEQUENCE OF 1P LED RED / 2P LED BLUE ▶TURNING ON IN SEQUENCE OF RED ▶ GREEN ▶ BLUE ▶ WHITE
	“ON”		TOTAL ON
	“ON/OFF”		REPEATION OF TOTAL ON, OFF
SLOPE SENSOR	=>		ENTER INTO CHECK MODE OF SLOPE SENSOR STATUS
	SLOPE SENSOR DETAIL FEDCBA9876543210 EX0:0000000000000000 EX1:0000000000000000 EX2:0000000000000000 EX3:0000000000000000 EX4:0000000000000000 EX5:0000000000000000 EX6:0000000000000000 EX7:0000000000000000		DISPLAY OF INPUT STATUS OF I/O EXPANSION BOARD WITH 0 AND 1. 0 - NOT SENSING SENSOR SIGNAL 1 - SENSOR SIGNAL DETECTED SLOPE LED : DISPLAY OF SENSOR STATUS #1~#50 BY LED COLOR WHITE COLOR - NOT SENSING SENSOR SIGNAL RED COLOR - SENSOR SIGNAL DETECTED RETRY FND [■ ■] : DISPLAY OF DETECTED SENSOR NO SCORE FND TOP [■ ■ ■] : DISPLAY OF SLOPE SENSOR (On, Err) SCORE FND BOTTOM [□ ■ ■] : DISPLAY OF SENSOR NO IN ERROR
	◎ UP/DOWN OPERATION OF STOPPER WITH 1P,2P START BUTTON		
	SLOPE LED: DISPLAY OF SENSOR STATUS BY LED COLOR WHITE: NOT SENSING SENSOR SIGNAL RED: SENSOR SIGNAL DETECTED RETRY FND : DISPLAY OF DETECTED SENSOR NO		

TICKET	OPERATION TEST OF TICKET DISPENSER ◎ SELECT TYPE WITH LEFT, RIGHT BUTTON AND PRESS SELECT BUTTON TO TEST ◎ TICKET BUTTON OF 1P AND 2P OPERATES SEPARATELY (DISPENSES 3 TICKETS)	
	"ALL"	OPERATION TEST OF ALL PLAYERS (DISPENSES 3 TICKETS)
	"1P", "2P"	INDIVIDUAL OPERATION TEST OF 1P AND 2P (3 TICKETS)
	SCORE FND TOP [■ ■ ■] : OPERATION STATUS OF TICKET DISPENSER, DISPLAY OF ON, OFF AND ERROR "Err" SCORE FND BOTTOM [□ □ ■] : DISPLAY OF NUMBER OF TICKETS DISPENSED CREDITFND [■ □] : DISPLAY OF TICKET BUTTON STATUS (0, 1) [□ ■] : DISPLAY OF TICKET DISPENSER SENSOR STATUS (0, 1)	
COUNTER	COUNTER TEST ◎ AFTER SELECTING TYPE WITH LEFT, RIGHT BUTTON, PRESS SELECT BUTTON AND THEN IT CREASES BY 1 ◎ COUNTER INCREASES BY ONE WH PRESSING 1P/2P SERVICE BUTTON	
	"COIN"	OPERATION OF COIN COUNER OF ALL PLAYERS INCREASES BY "1" IN ORDER OF 1P → 2P
	"TICKET"	OPERATION OF TICKET COUNTER OF ALL PLAYERS INCREASES BY "1" IN ORDER OF 1P → 2P
SOUND TEST	SOUND TEST ◎ AFTER SELECTING TYPE WITH LEFT, RIGHT BUTTON AND PRESS SELECT TO TEST (PLAY, STOP)	
	"CH"	VOICE OUTPUT PER EACH CHANNEL SPEAKER ONE, TWO ~ EIGHT LEFT : 1, 3, 5, 7 RIGHT : 2, 4, 6, 8
	"BGM"	OUTPUT TEST OF BACKGROUND MUSIC
	"SFX"	OUTPUT TEST OF EFFECT MUSIC
	"VOC"	VOICE OUTPUT TEST
EXIT	EXIT TO OPERATING OPTIONS	

[3. TROUBLESHOOTING]

* General check up : Check the supply voltage and wiring connection properly
* "NO" : Means faulty of the check up result.

1. BIGWIN MOTOR ERROR [Er. 31 or Er. 32]

BIGWIN MOTOR

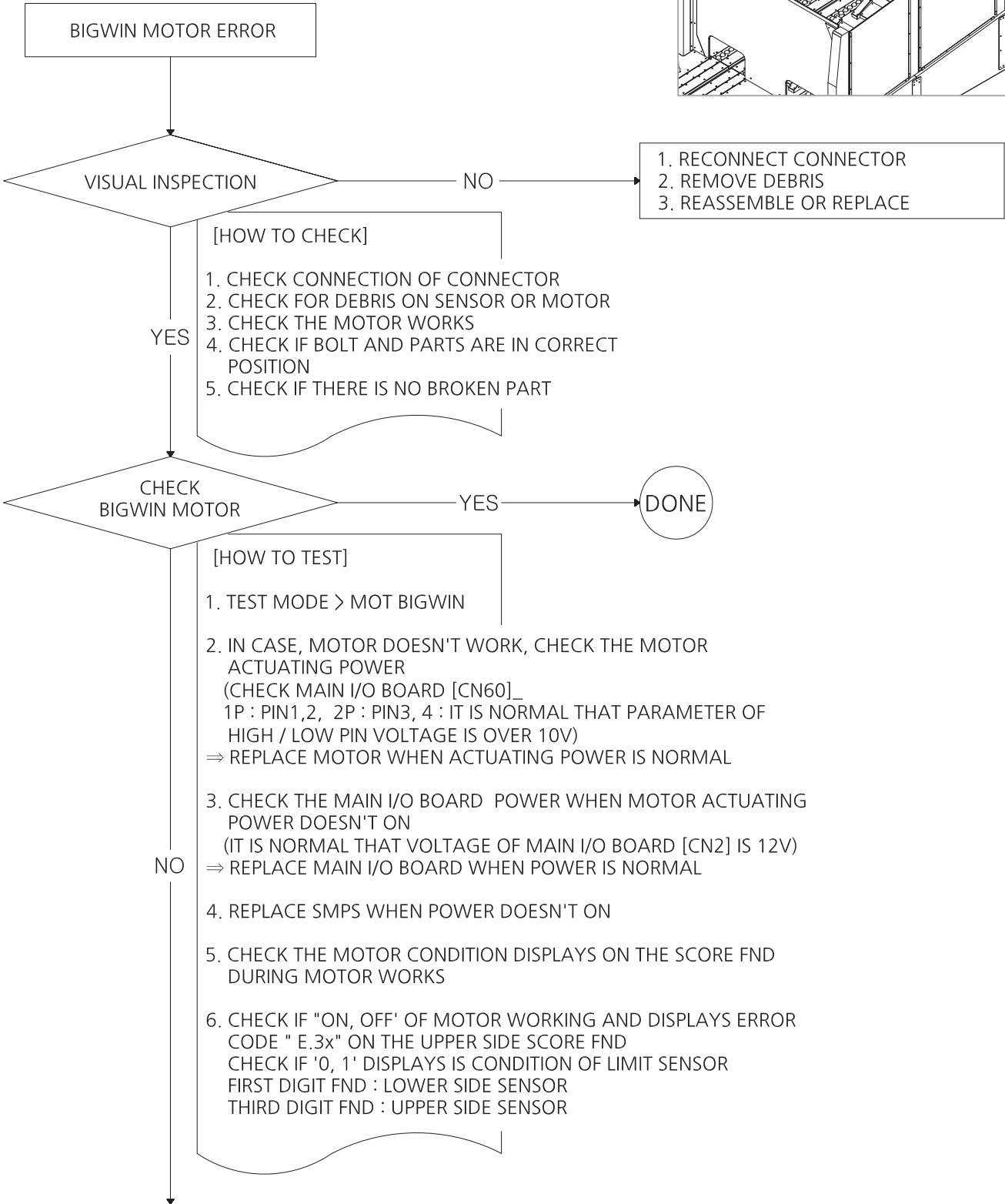
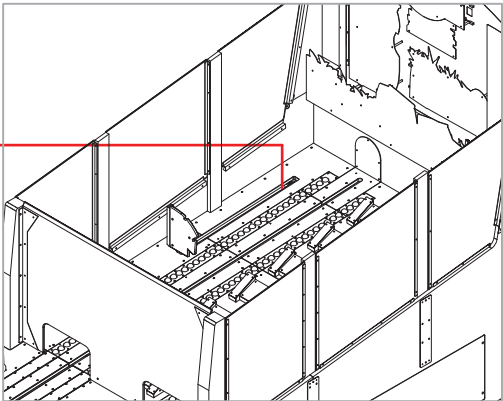

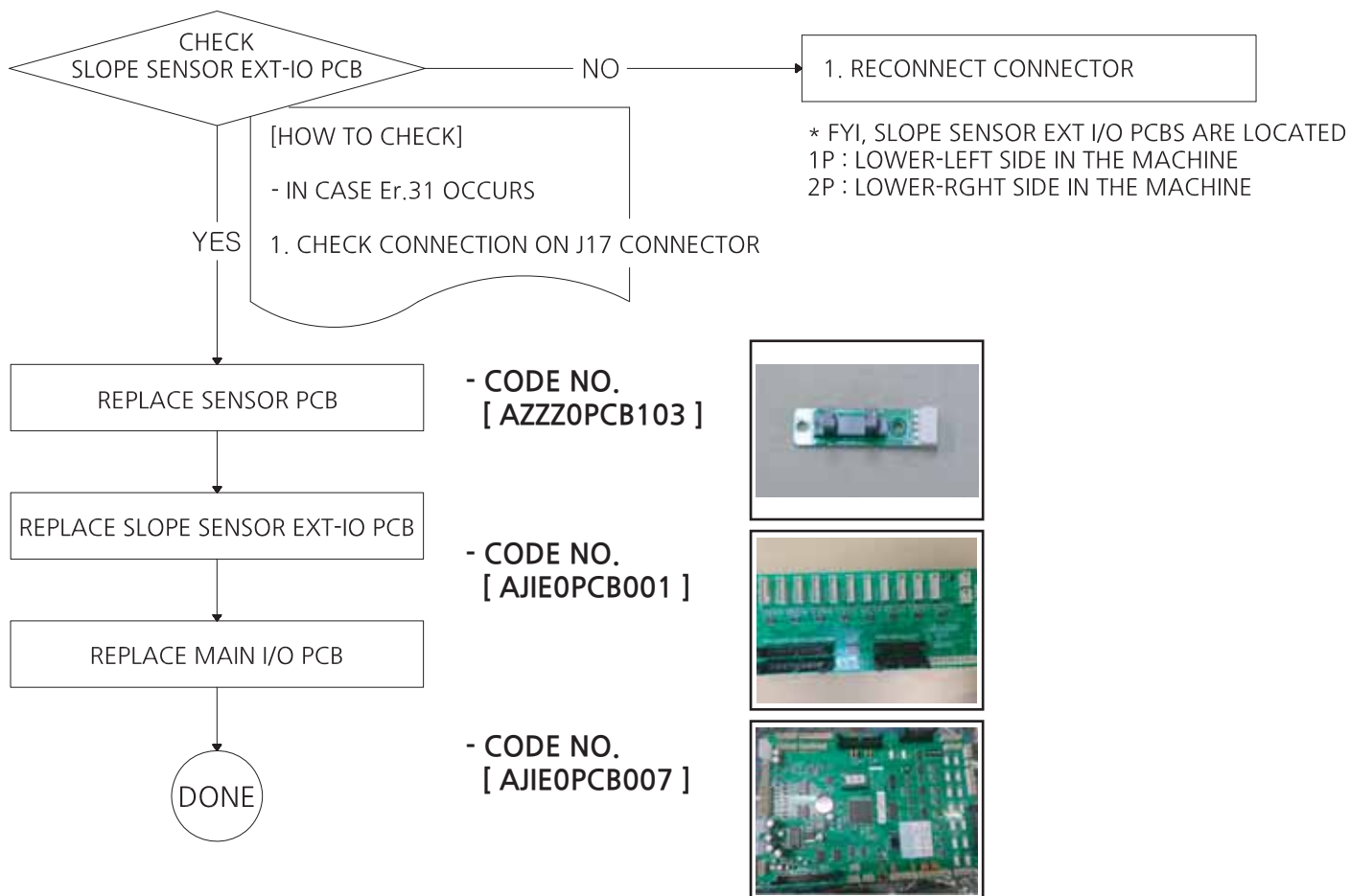

2. BIGWIN MOTOR ERROR [Er. 33 or Er. 34]

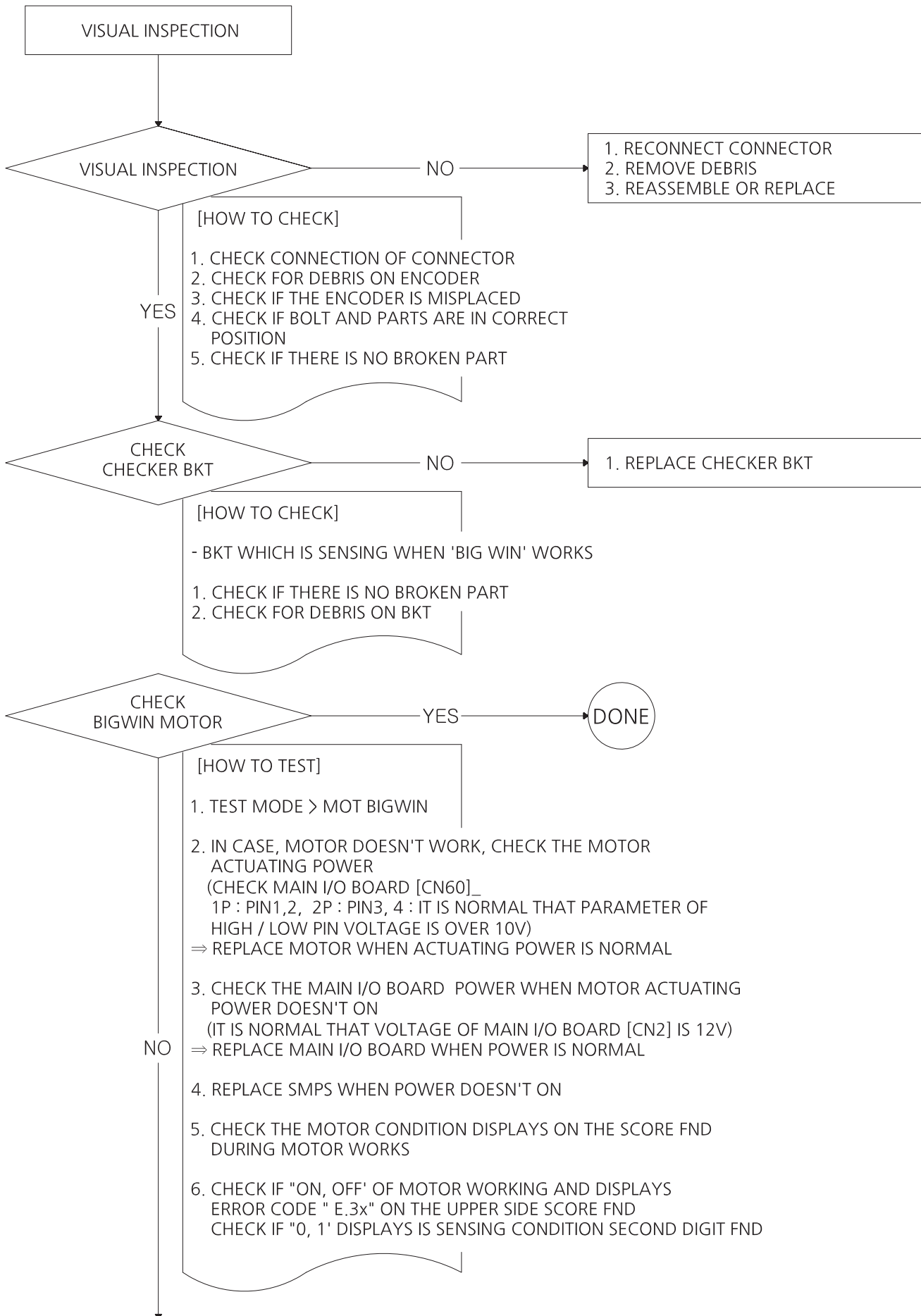

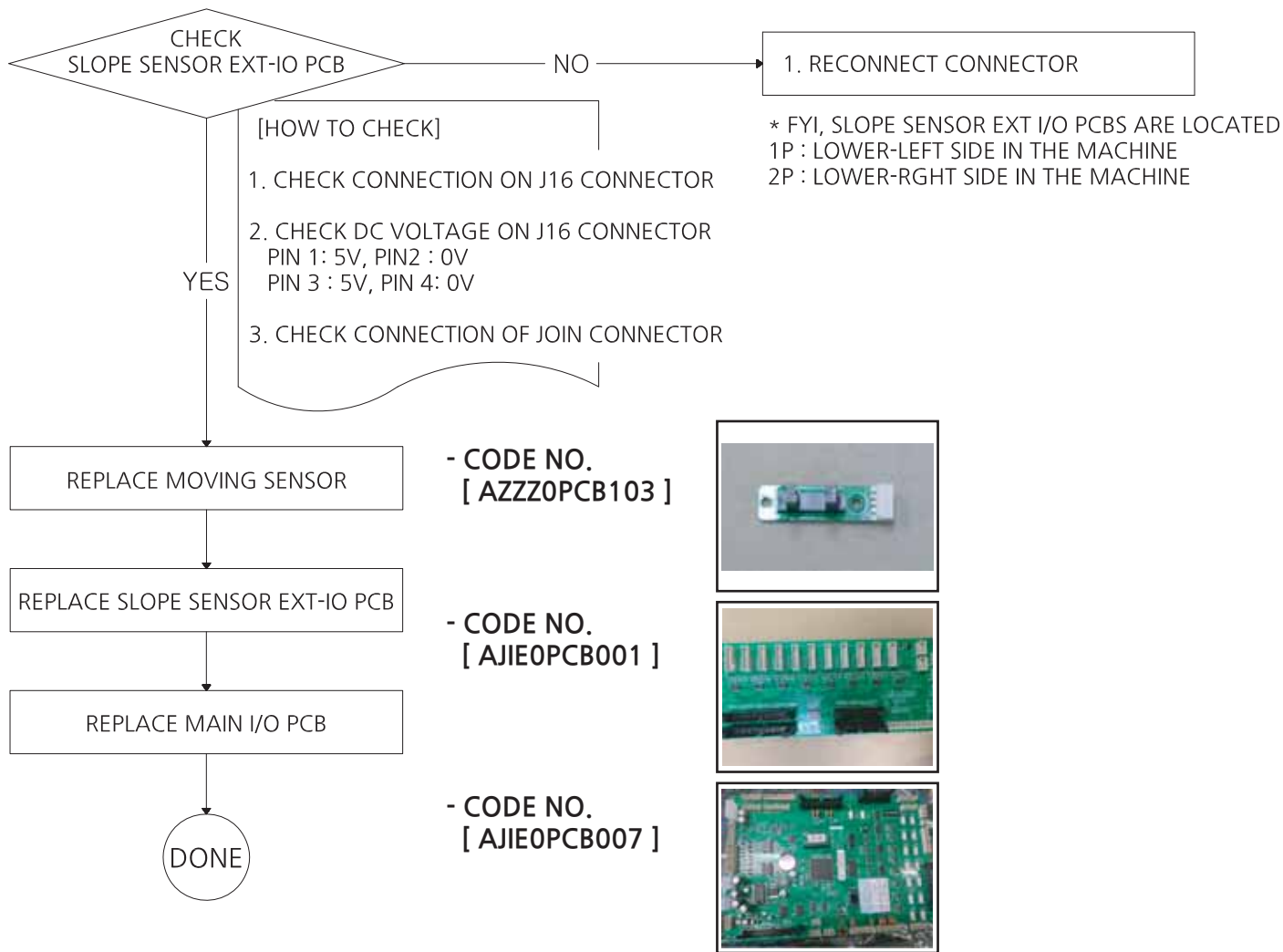

3. SLOPE SENSOR ERROR [Er. 51 or Er. 52]

SLOPE SENSOR

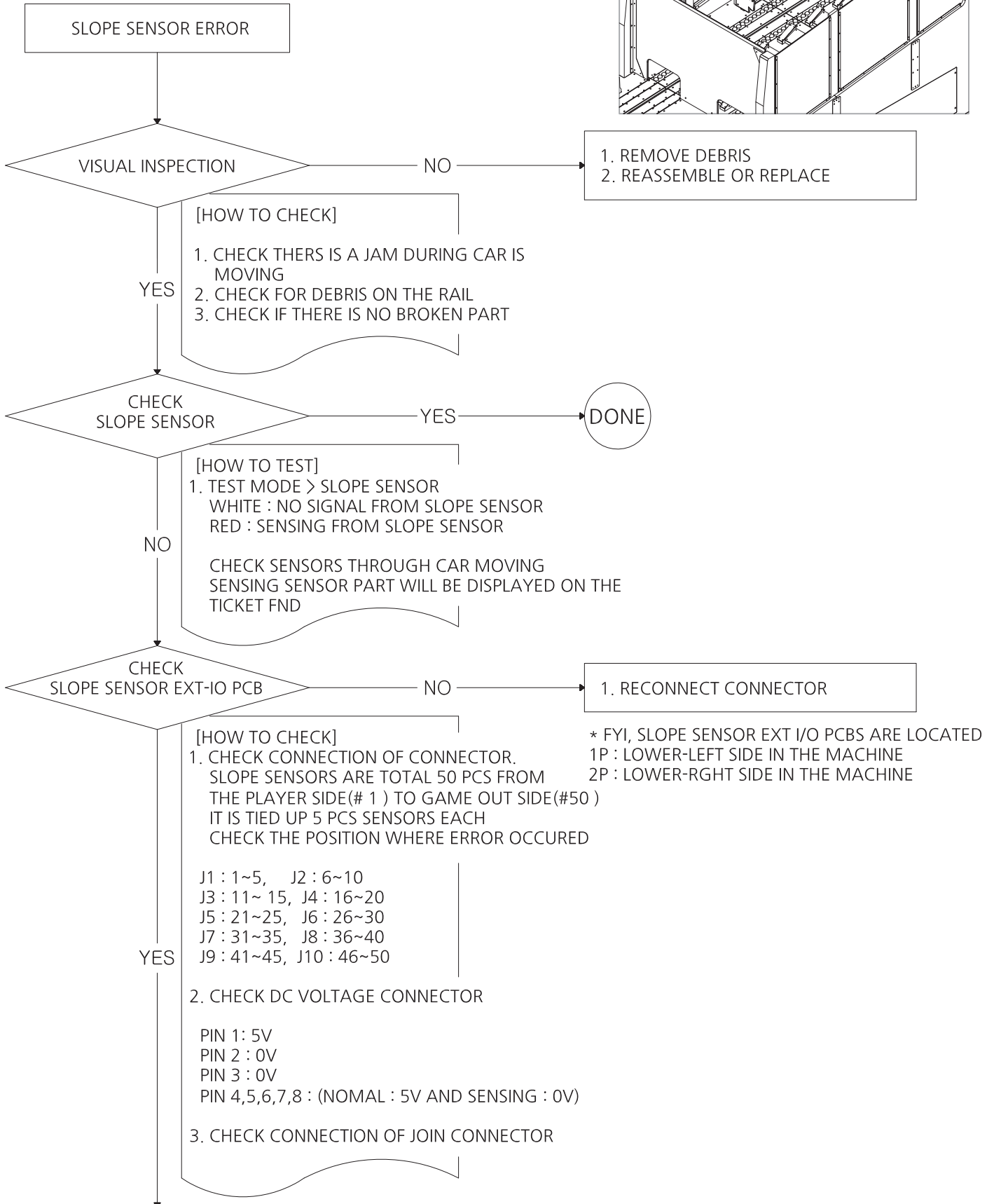
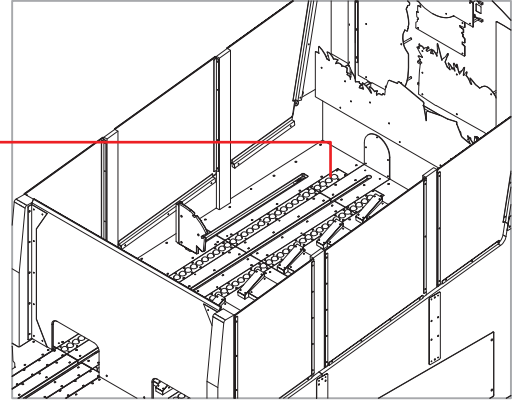

REPLACE SLOPE SENSOR EXT-IO PCB



REPLACE MAIN I/O PCB



DONE

- CODE NO.
[AJIE0PCB001]



- CODE NO.
[AJIE0PCB007]



4. SLOPE SENSOR ERROR [Er. 53]

SLOPE SENSOR

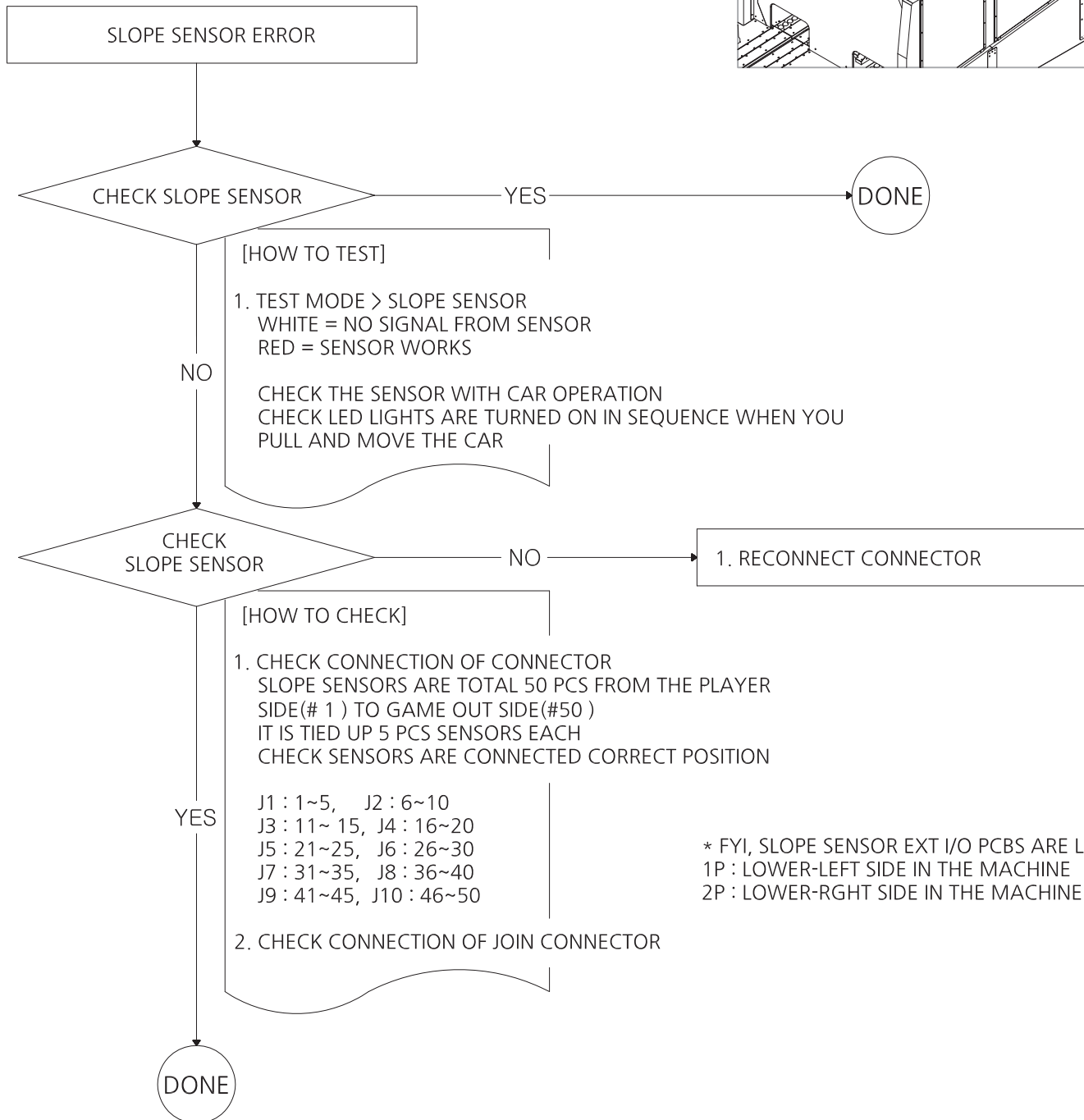
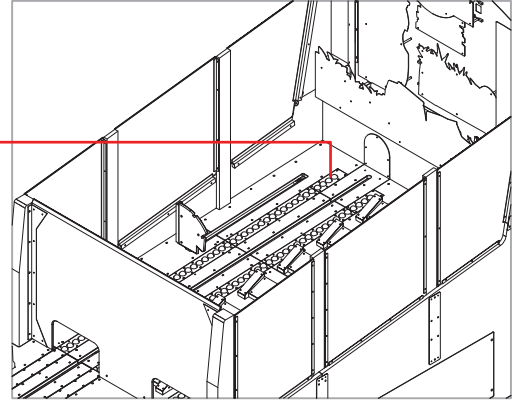

* FYI, SLOPE SENSOR EXT I/O PCBS ARE LOCATED
 1P : LOWER-LEFT SIDE IN THE MACHINE
 2P : LOWER-RGHT SIDE IN THE MACHINE

5. STOPPER MOTOR ERROR [Er. 41 or Er. 42] - NO SIGNAL FROM ENCODER

IN CASE STOPPER MOTOR DOES NOT WORK

STOPPER MOTOR

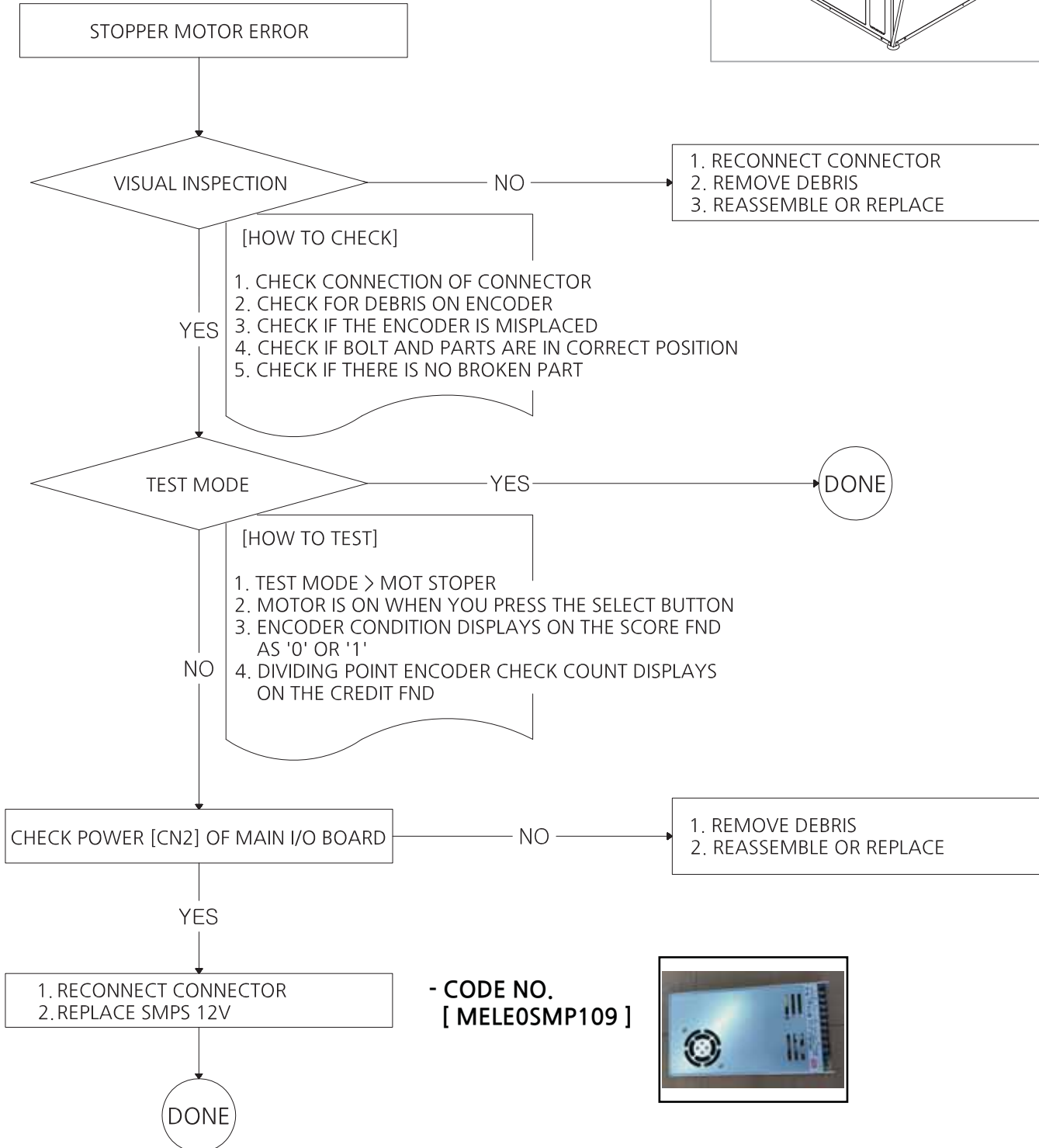
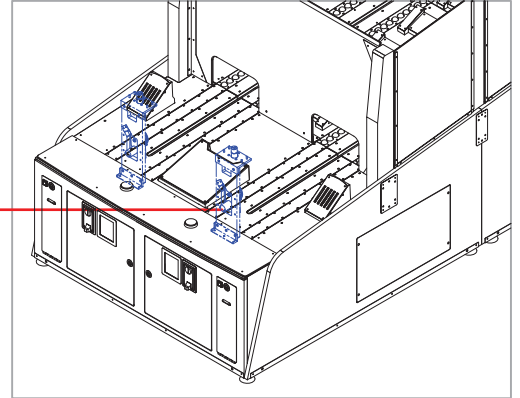

IN CASE STOPPER MOTOR NOT WORK

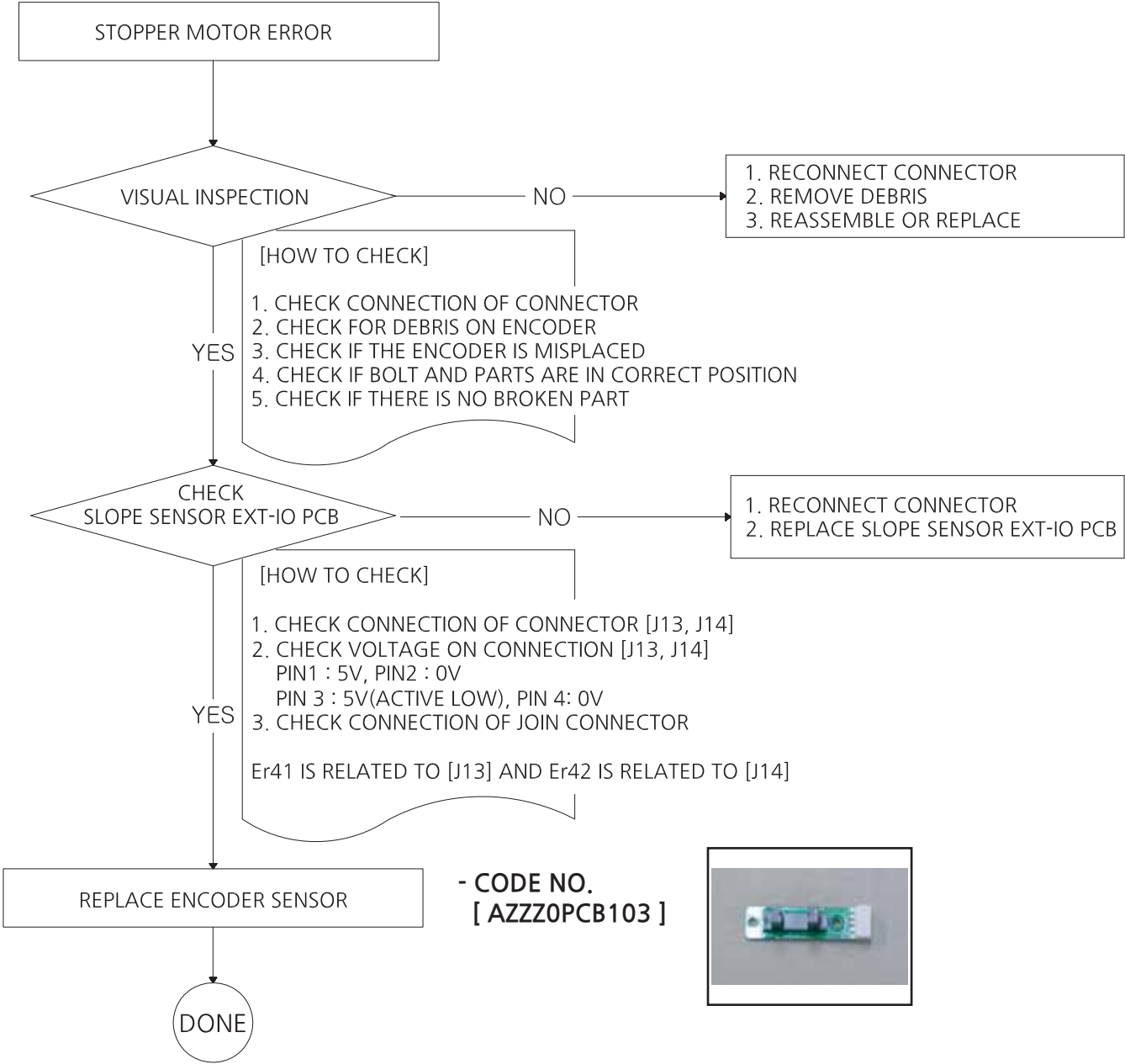

[4. WARRANTY ITEM & PART PICTURE]

- BACKGROUND PART

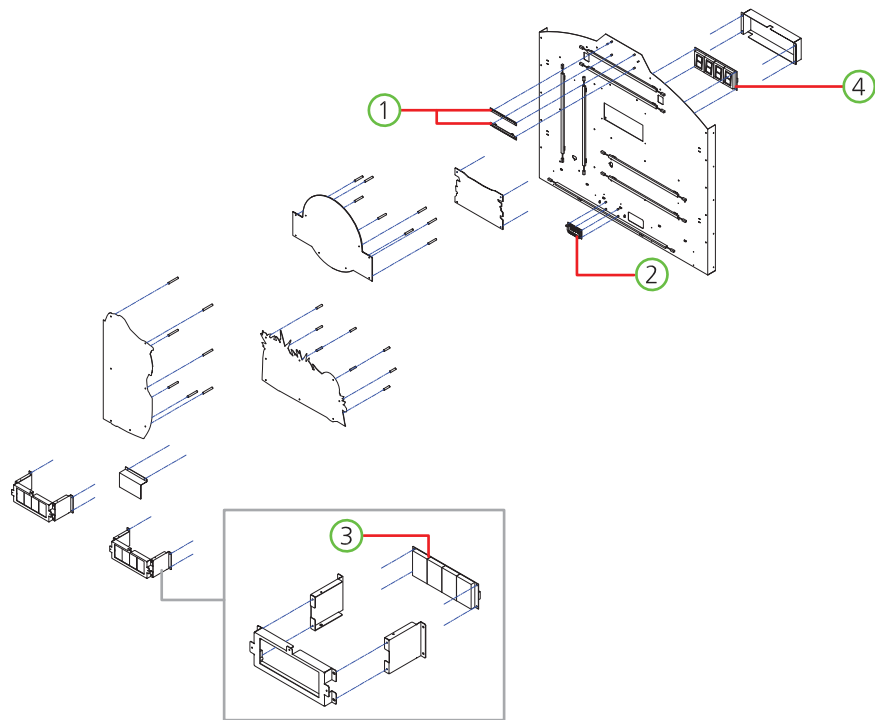

- MAIN BOARD BOX PART

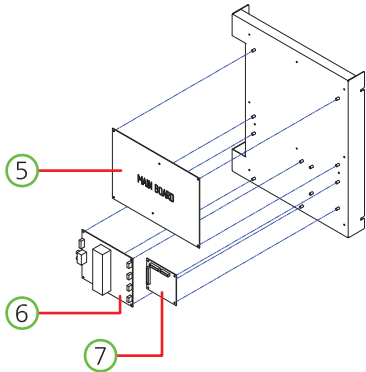

- FRONT SIDE PCB PART

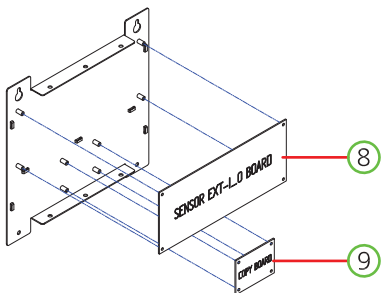

- CONTROL PANEL PART

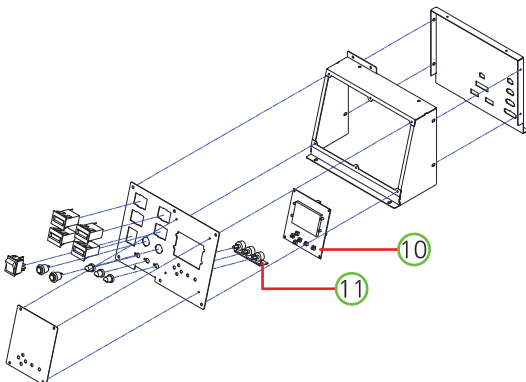

- FRONT DECO-L, R PART

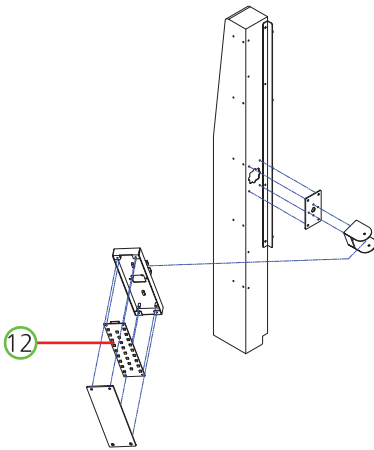

- SIDE LED SENSOR-L, R PART

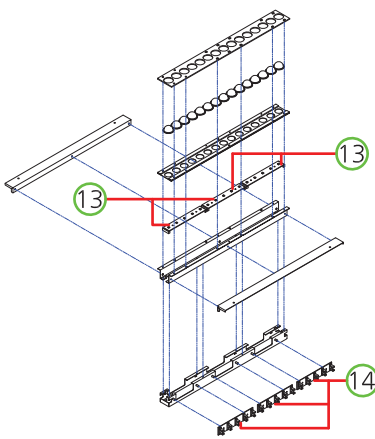

- SIDE GO LED-L, R PART

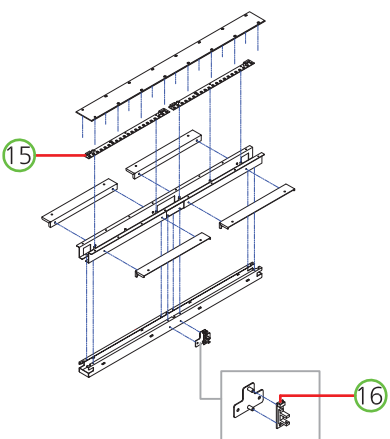

- SIDE LED NO SENSOR-L, R PART

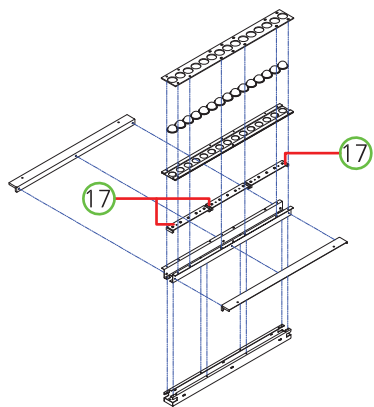

- CAR STOPPER PART

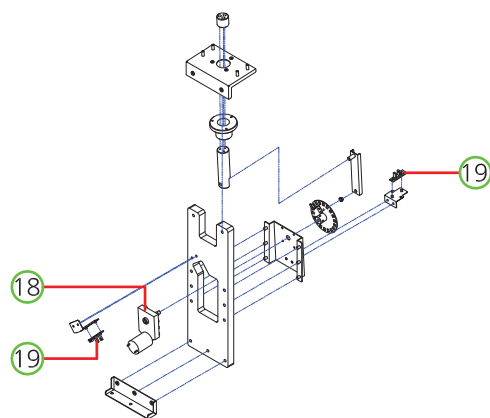

- FRONT CENTER COVER PART

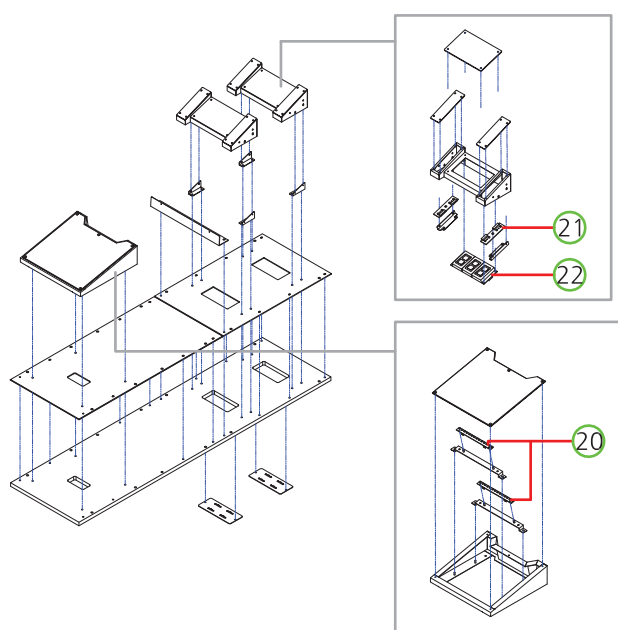

- BUTTON PART

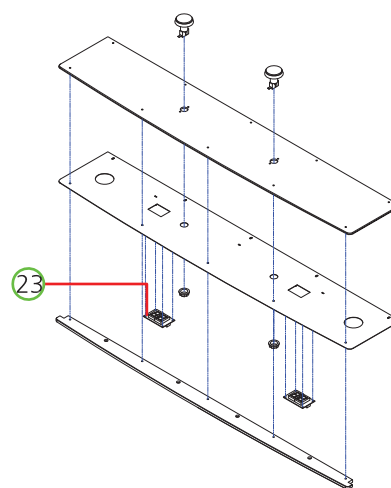

- SMPS POWER PART

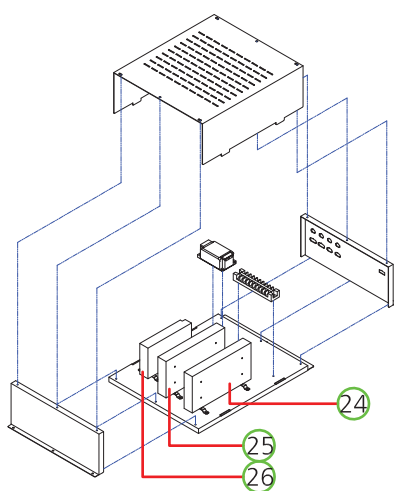

- BIGWIN MOVEMENT-L, R

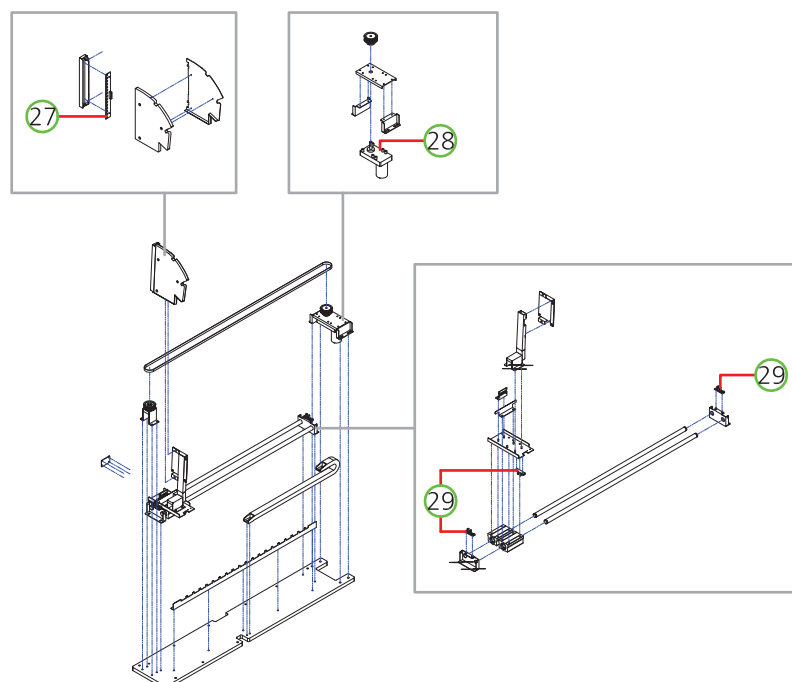

- SIDE LED-L, R SENSOR LAST PART

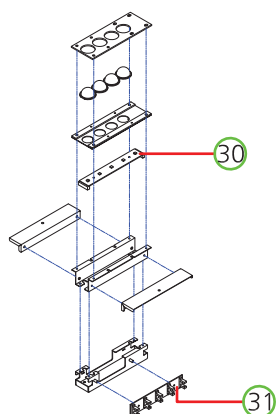

- SIDE LED-L, R NO SENSOR LAST PART

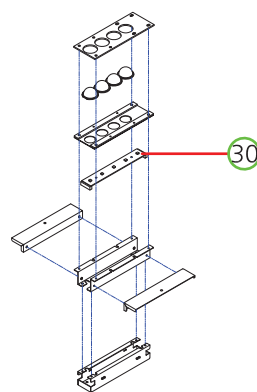

- REAR CENTER COVER PART

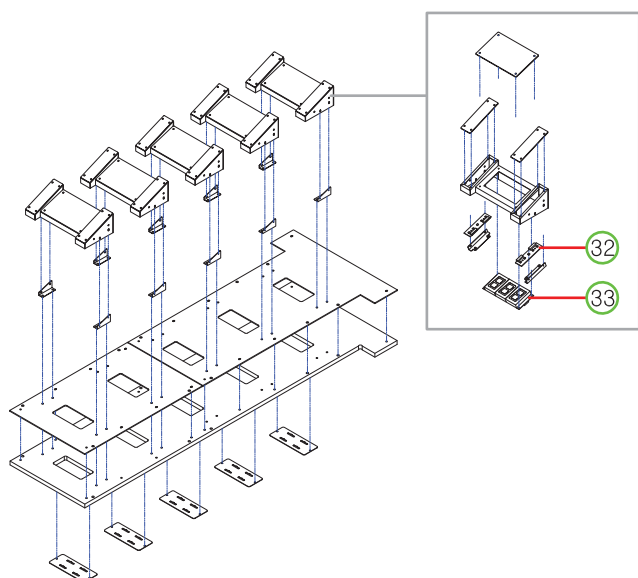



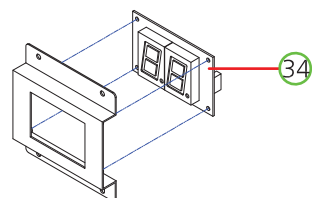

- FND PART













NO.	PIC	PART NAME	SPEC.	QTY	CODE NO.	WARRANTY	
						6 Month	One Year
①	○	JWIE LED PCB ASS'Y	WHITE 14EA	2	AJIE0PCB006		○
②	○	FND EXT IO PCB ASS'Y	90x50 16BIT EXT	1	ABSP0PCB005		○
③	○	FND PCB ASS'Y	4870-4(STRAIGHT)	1	AFND0PCB009		○
④	○	FND PCB ASS'Y	6390-4(STRAIGHT)	1	AFND0PCB011		○
⑤	○	MAIN IO PCB ASS'Y	-	1	AJIE0PCB007		○
⑥	○	DIGITAL AMP PCB ASS'Y	2.1CH	1	APUJ0PCB002		○
⑦	○	WS2812B IO PCB ASS'Y	-	1	AZZZ0PCB185		○
⑧	○	SLOPE SENSOR EXT IO PCB ASS'Y	64 PORT	1	AJIE0PCB001		○
⑨	○	DISPLAY COPY PCB ASS'Y	-	1	AGST0PCB008		○
⑩	○	SETUP LCD PCB ASS'Y	-	1	AZZZ0PCB113		○
⑪	○	VOLUME PCB ASS'Y	3CH	1	APUJ0PCB005		○
⑫	○	SPOT LED PCB ASS'Y	WHITE	1	ABAP0PCB008		○
⑬	○	SIDE LED PCB ASS'Y	RGB 5EA	3	AJIE0PCB003		○
⑭	○	SLOPE SENSOR (INT1x5) PCB ASS'Y	-	3	AJIE0PCB002		○
⑮	○	WS2813B LED PCB 21EA-R ASS'Y	21EA-R	2	APLX0PCB008		○
⑯	○	PHOTO INT-1 PCB ASS'Y	-	1	AZZZ0PCB103		○
⑰	○	SIDE LED PCB ASS'Y	RGB 5EA	3	AJIE0PCB003		○
⑱	○	MOTOR	KGE-3448S1, 62:1	1	MZZZ0MOT157	○	
⑲	○	PHOTO-INT1_ANGLE PCB ASS'Y	-	2	AZZZ0PCB103		○
⑳	○	JWIE LED PCB ASS'Y	WHITE 14EA	2	AJIE0PCB006		○
㉑	○	SCORE LED PCB ASS'Y	RGB 5EA	4	AJIE0PCB004		○
㉒	○	FND PCB ASS'Y	4870-3(STRAIGHT)	2	AFND0PCB027		○
㉓	○	FND PCB ASS'Y	2941-2(STRAIGHT)	2	AFND0PCB003		○
㉔	○	POWER SMPS	RSP-320-5V	1	MELE0SMP126		○
㉕	○	POWER SMPS	RSP-320-12V	1	MELE0SMP109		○
㉖	○	POWER SMPS	LRS-150F-24V	1	MELE0SMP085		○
㉗	○	BIG WIN MAKER RGB LED PCB ASS'Y	-	1	AJIE0PCB005		○
㉘	○	MOTOR	KGV-ND3657U1, 60:1	1	MZZZ0MOT156	○	
㉙	○	PHOTO-INT1_ANGLE PCB ASS'Y	-	1	AZZZ0PCB103		○
㉚	○	SLOPE SENSOR PCB ASS'Y	INT1x5	2	AJIE0PCB002		○
㉛	○	SIDE LED PCB ASS'Y	RGB 5EA	1	AJIE0PCB003		○
㉜	○	SCORE LED PCB ASS'Y	RGB 5EA	2	AJIE0PCB004		○
㉝	○	FND PCB ASS'Y	4870-3(STRAIGHT)	5	AFND0PCB027		○
㉞	○	FND PCB ASS'Y	2941-2(STRAIGHT)	2	AFND0PCB003		○

1	2	3	4	5	6
					
AJIE0PCB006	ABSP0PCB005	AFND0PCB009	AFND0PCB011	AJIE0PCB007	APUJ0PCB002

7	8	9	10	11	12
					
AZZZ0PCB185	AJIE0PCB001	AGST0PCB008	AZZZ0PCB113	APUJ0PCB005	ABAP0PCB008

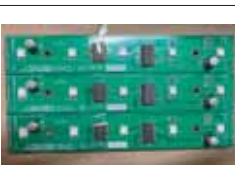
13	14	15	16	17	18
					
AJIE0PCB003	AJIE0PCB002	APLX0PCB008	AZZZ0PCB103	AJIE0PCB003	MZZZ0MOT157

19	20	21	22	23	24
					
AZZZ0PCB103	AJIE0PCB006	AJIE0PCB004	AFND0PCB027	AFND0PCB003	MELE0SMP126

25	26	27	28	29	30
					
MELE0SMP109	MELE0SMP085	AJIE0PCB005	MZZZ0MOT156	AZZZ0PCB103	AJIE0PCB002
31	32	33	34		
					
AJIE0PCB003	AJIE0PCB004	AFND0PCB027	AFND0PCB003		